

Hanging Rope Installation

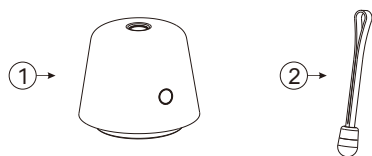

Product list: ① Lamp head ② Hanging rope

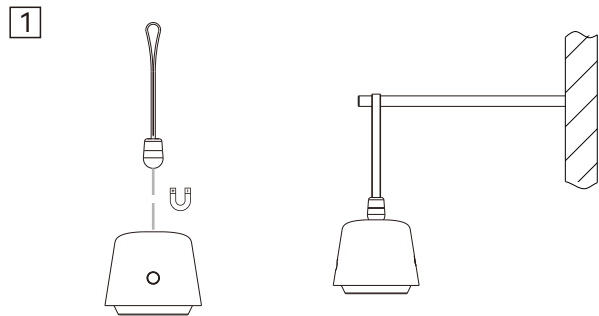
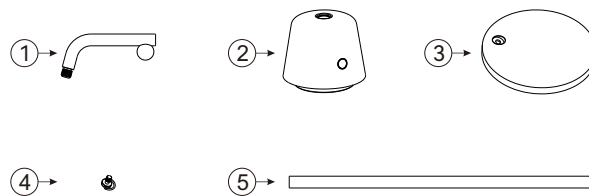
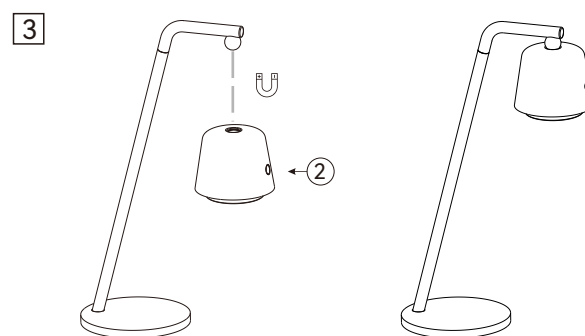
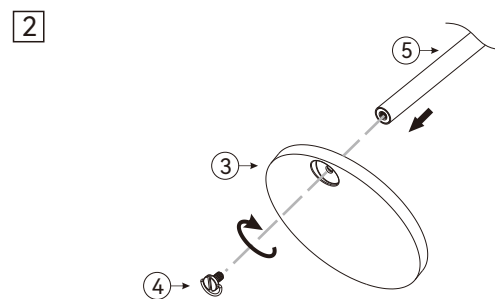
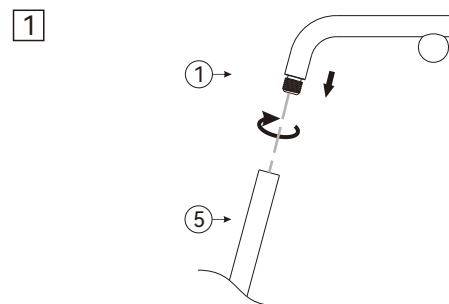

Table Lamp Installation Manual



Product list: ① Top part of pole ② lamp head ③ Base ④ M6 screw ⑤ Pole



Free Standing Lamp Installation Manual

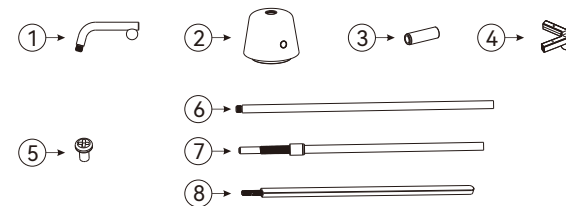

Product list: ① Top part of pole ② Lamp head ③ Free standing nut ④ Tripod ⑤ M3 screws 2pcs ⑥ Free standing pole 3pcs ⑦ Free standing guide pole ⑧ Free standing support pole 2pcs

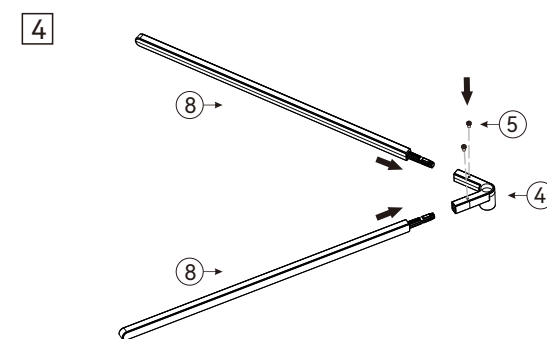
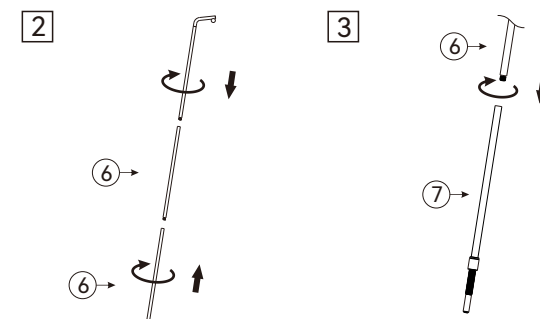
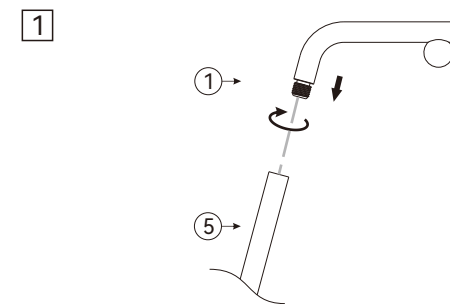

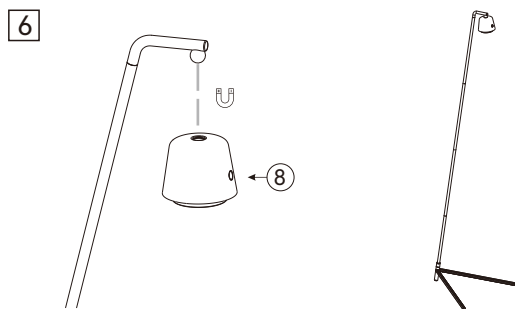
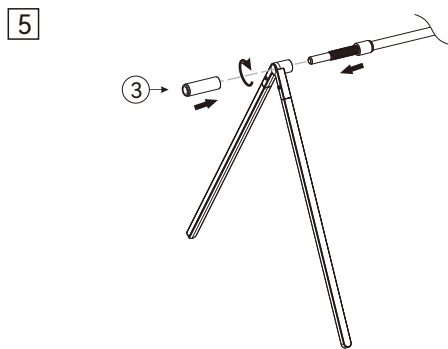

Spike Installation Manual

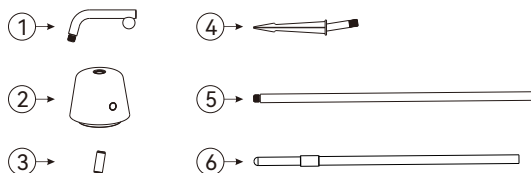

Product list: ① Top part of pole ② Lamp head ③ Spike nut ④ Spike
⑤ Free standing installation pole 3PCS ⑥ Spike guide pole

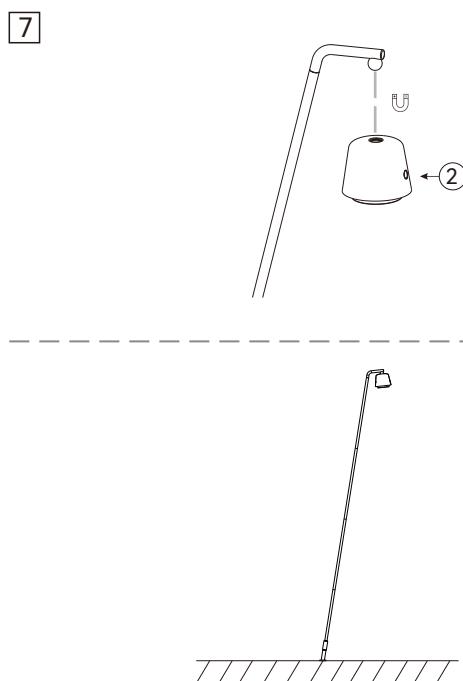
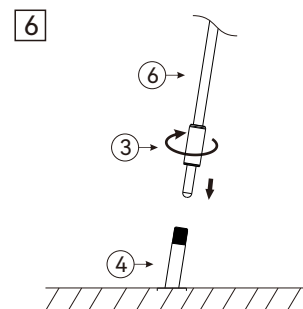
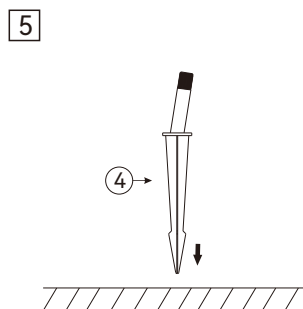
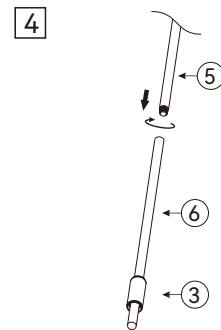
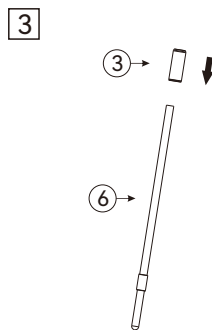
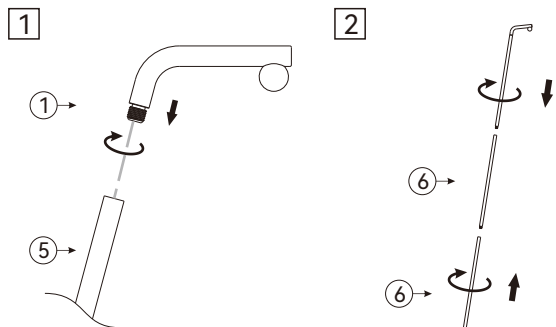

Manual

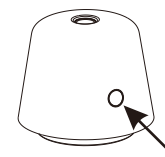

Switch & Dimming Button

Short press to turn on/off the lamp, long press to dim;
(The first long press dims the brightness, the second long press brightens the brightness, The subsequent long presses cycle from brightest to darkest, the total dimming time from brightest to darkest is 3 seconds)

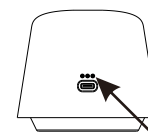

Charging Indicator

Power Status Indicator

Each time the light is turned on, if the battery level is above 10%, the indicator lights will illuminate as follows:

illuminate as follows:

When the battery level is between 67% and 100%, all three indicator lights will glow white;

When the battery level is between 34% and 66%, two indicator lights will glow white;

When the battery level is between 10% and 33%, one indicator light will glow white;

After 10 seconds, the indicator lights automatically turn off.

When the battery level is below 10%, the indicator light stays on red;

When the battery level is below 3%, the light automatically turns off, and the indicator light

flashes white for 30 seconds before automatically turning off;

When the battery level is below 3%, if the user turns on the light, the light does not illuminate,

and the indicator light flashes for 10 seconds before automatically turning off.

Charging Status Indicator

During charging:

When the lamp's battery level is between 0% and 33%, the first indicator light flashes white;

When the lamp's battery level is between 34% and 66%, the first indicator light stays on white, and the second indicator light flashes white;

When the lamp's battery level is between 67% and 99%, the first and second indicator lights stay on white, and the third indicator light flashes white;

When the lamp is fully charged, all three indicator lights remain lit in white;

When charging is removed, the indicator lights automatically turn off.

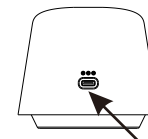

Type-C charging port

When the lamp is fully charged, it can be used for 6 hours (± 1 hour), Charging time is 4.5 hours (± 1 hour), and the lamp can be used normally during charging.