

Installation instruction

Length	A
1.2m	1186mm
1.5m	1506mm

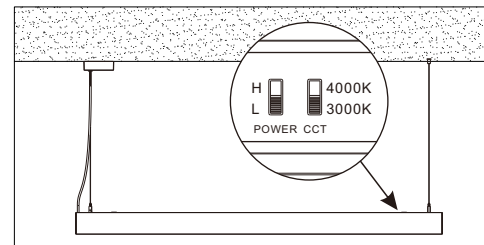

Installation instruction

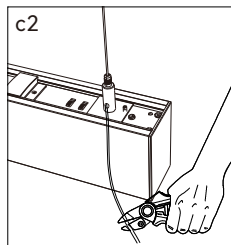
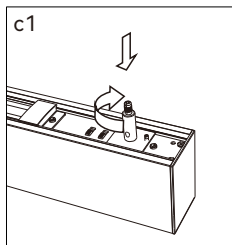
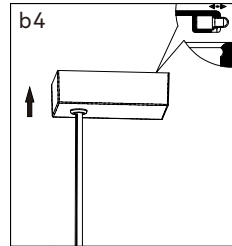
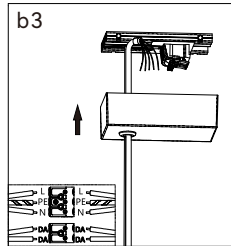
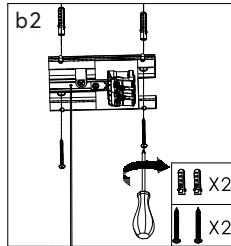
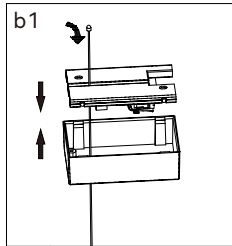
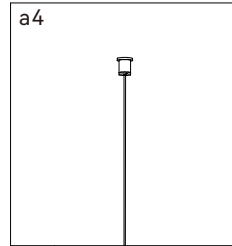
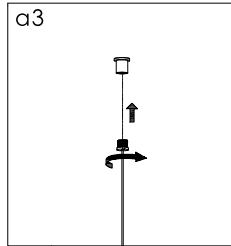
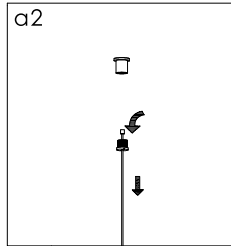
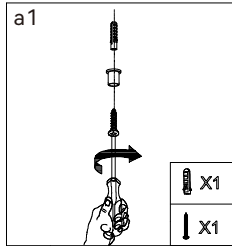
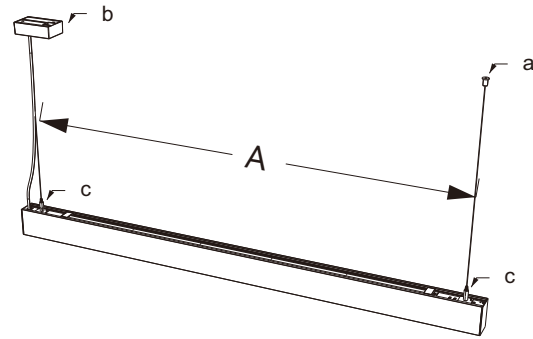
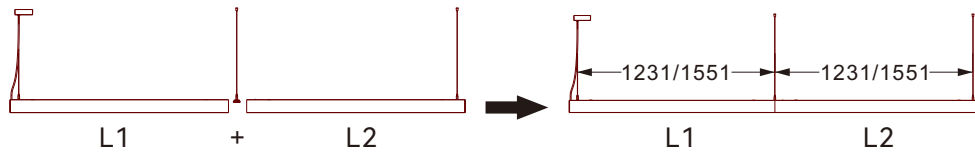

Friendly reminder: one AC input cable support 10pcs lamp link together

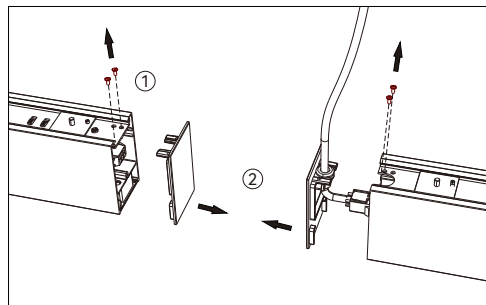
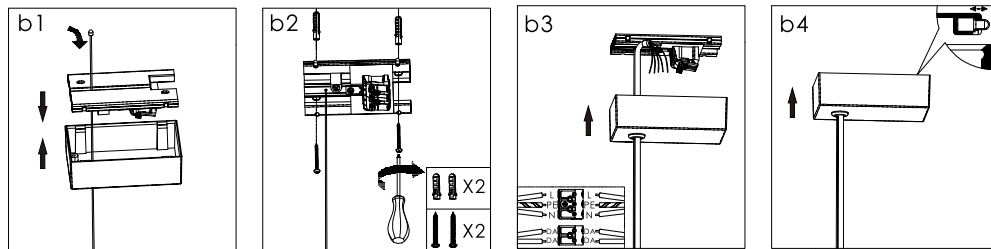
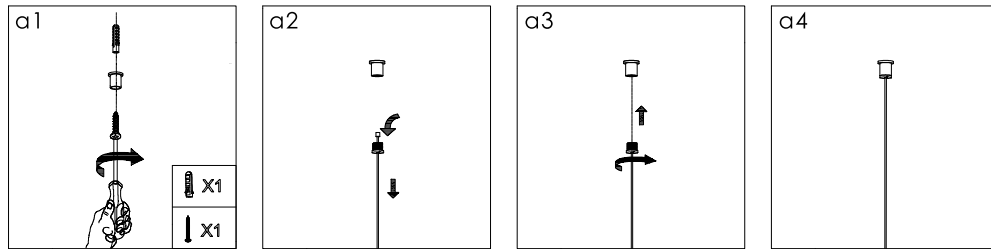

Loosen screw 1 as shown in the figure and remove the end cover on the side to be connected

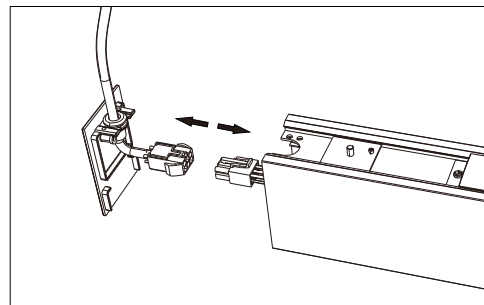

Remove the power cord at the desired link by disconnecting the pairs of terminals.

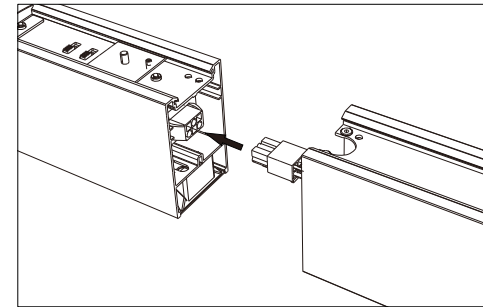

Pair up the cables.

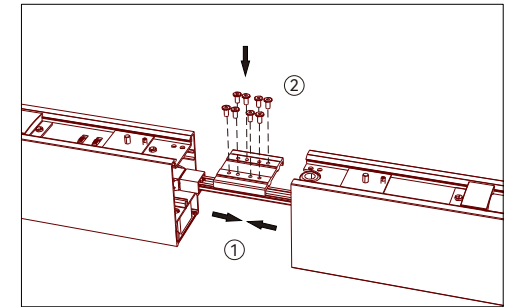

Secure the cascade block to the lamp body with screws.

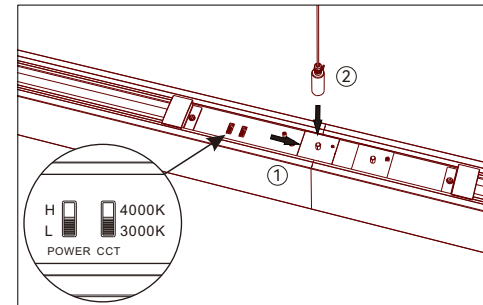

Lock the screws, adjust the wire rope to the appropriate height, tighten the screws, and secure the wire rope.

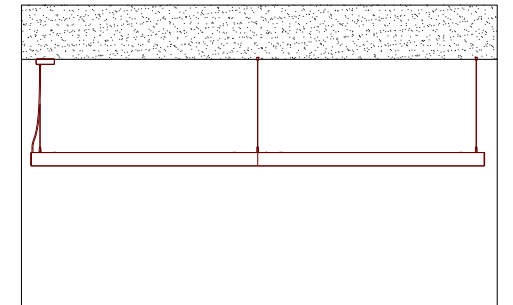

Complete the installation